

富川瑶族自治县白沙镇中心校宗地草图

2729.955-541.395

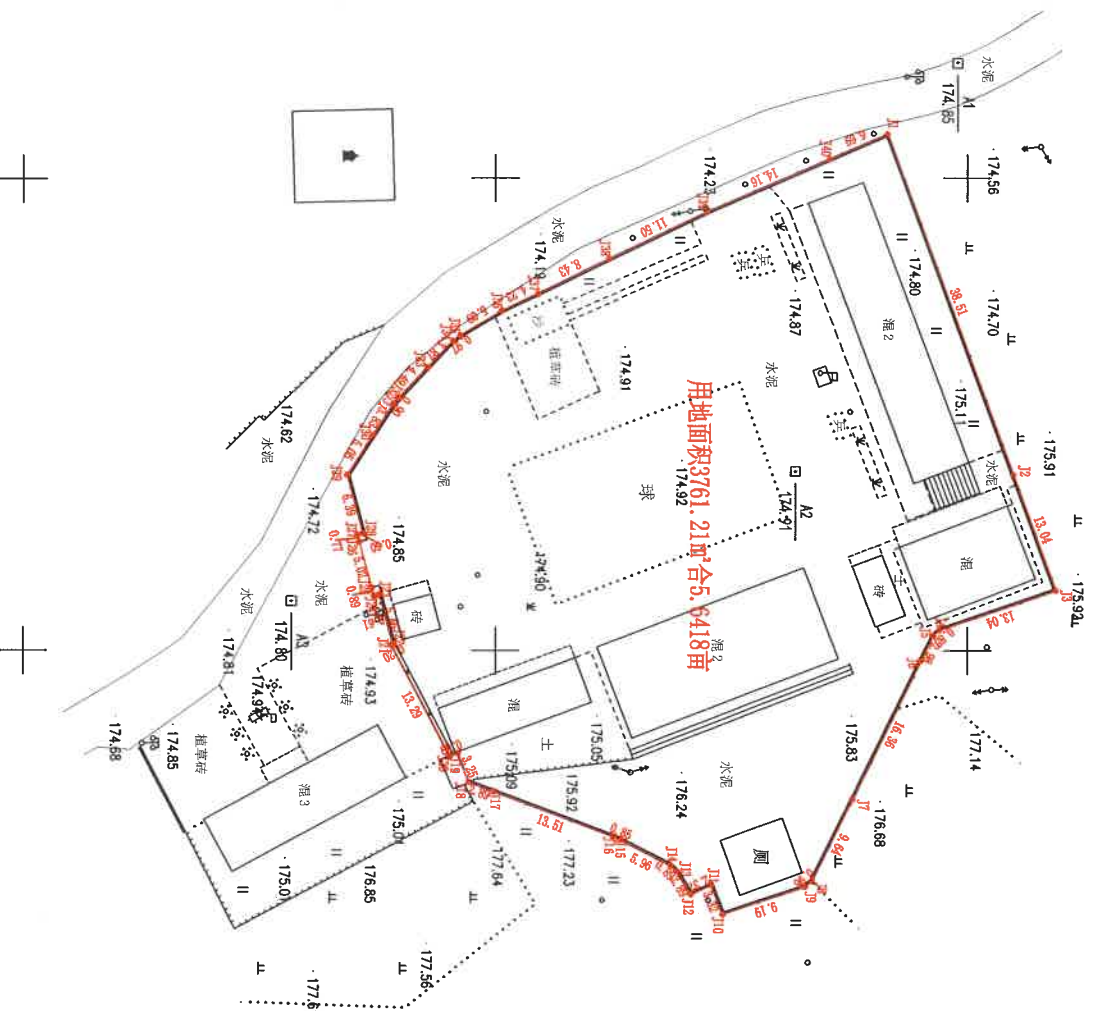
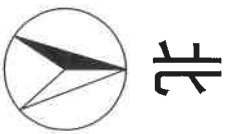

用地面积3761.21㎡合5.6418亩

说明：图中红线范围由委托方现场指定，面积为3761.21平
日期：2022年8月。



富川方圆测绘服务有限公司

点号	X	Y	边长
J1	2730096.214	541439.811	38.51
J2	2730109.549	541475.940	13.04
J3	2730114.061	541488.172	13.04
J4	2730101.717	541492.365	0.85
J5	2730101.073	541492.921	2.98
J6	2730099.745	541495.590	16.36
J7	2730092.487	541510.247	9.64
J8	2730088.174	541518.872	0.96
J9	2730087.450	541519.486	9.19
J10	2730078.742	541522.426	3.32
J11	2730077.555	541519.322	2.37
J12	2730075.395	541520.308	2.89
J13	2730073.879	541517.843	0.89
J14	2730073.228	541517.235	5.96
J15	2730067.912	541514.543	0.85
J16	2730067.133	541514.194	13.51
J17	2730064.487	541509.437	2.89
J18	2730061.782	541508.420	3.25
J19	2730050.630	541505.385	0.89
J20	2730049.803	541505.699	13.29
J21	2730043.628	541493.934	0.20
J22	2730043.801	541493.843	5.46
J23	2730042.359	541488.579	0.61
J24	2730041.768	541488.737	0.89
J25	2730041.539	541487.877	5.02
J26	2730040.229	541483.030	0.77
J27	2730040.043	541482.283	0.60
J28	2730040.623	541482.138	6.39
J29	2730038.971	541475.961	5.05
J30	2730041.732	541471.728	3.83
J31	2730043.837	541468.527	0.90
J32	2730044.404	541467.823	4.49
J33	2730047.490	541464.561	3.87
J34	2730050.154	541461.754	0.97
J35	2730050.932	541461.169	5.09
J36	2730055.323	541458.587	4.23
J37	2730059.142	541456.777	8.43
J38	2730066.707	541453.054	11.50
J39	2730077.086	541448.086	14.16
J40	2730090.074	541442.455	6.69
J41	2730096.214	541439.811	

S=3761.21 平均 85.6418

2000国家大地坐标系。
1985国家高程基准，等高距为1米。
2007版图式。
2022年08月数字化成图。

附注：测量员：邓楠、何坤
绘图员：林杰
审核员：何珂

1:800